

**713-376**  
**Guardian System - Composite**  
**Convoluted Tubing to Bulkhead Feed-Thru Fitting**  
**for Series 72 Annular Convolute Tubing**

**Composite Guardian System convoluted tubing to bulkhead feed-thru fitting**

**B**



**How To Order**

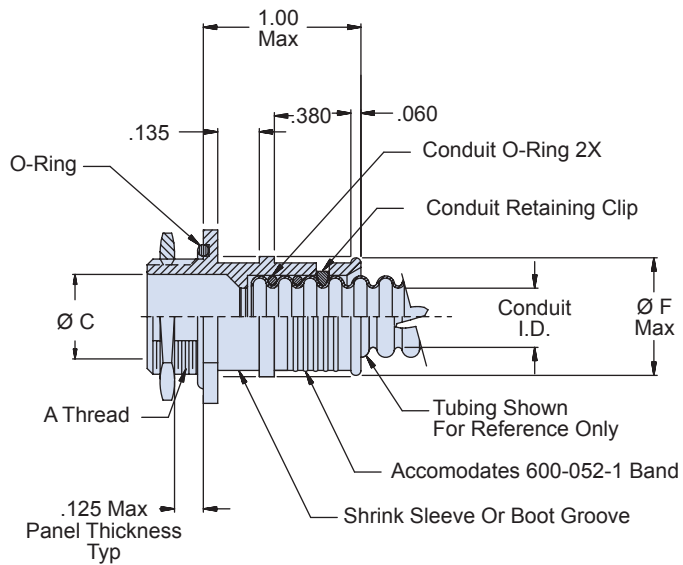
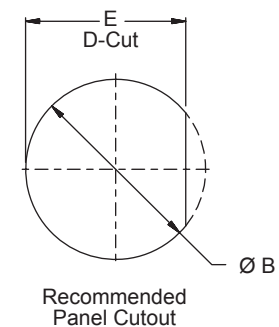
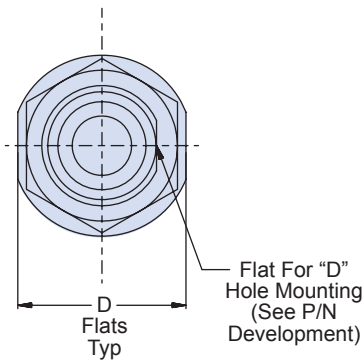
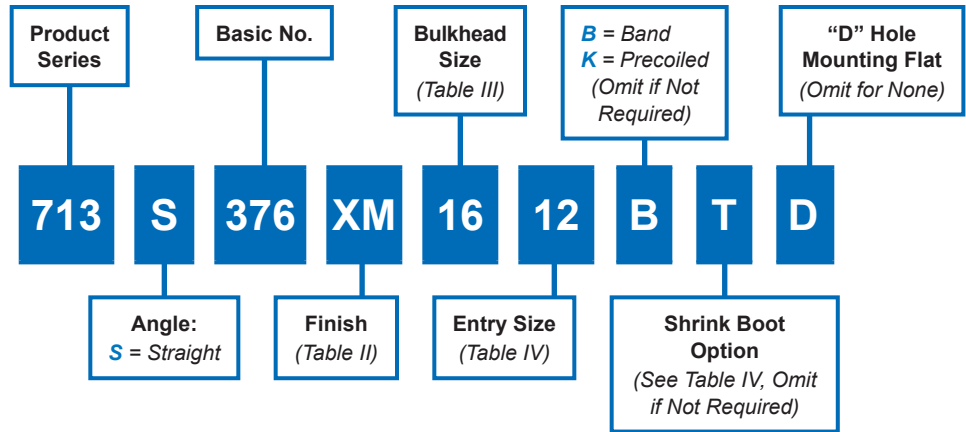

**Material and Finish**

- Adapter and Jam nut: High grade engineering thermoplastic/See Table II
- O-Rings: Silicone/NA
- Retaining clip: High grade engineering thermoplastic/no plating

**Tools and Assembly notes**

- Conduit retaining clip and conduit O-Ring to be supplied unassembled
- For effective grounding, connector with conductive finish should be used
- Glenair assembly procedure is recommended for adapter to conduit termination. See Guardian assembly procedure at the end of this section

713-376

**Guardian System - Composite  
Convuluted Tubing to Bulkhead Feed-Thru Fitting  
for Series 72 Annular Convuluted Tubing**

Series 72  
Annular Tubing

B

Table III: Bulkhead Size/Dimensions

Bulkhead Size	A Thread Class 2A	Ø B +.015 -.000	Ø C	D Flats	E +.010 -.000	Max Entry Size
06	7/16-28 UNEF	0.443 (11.3)	0.188 (4.8)	0.688 (17.5)	0.385 (9.8)	09
08	1/2-20 UNF	0.505 (12.8)	0.250 (6.4)	0.750 (19.1)	0.448 (11.4)	12
09	9/16-24 UNEF	0.568 (14.4)	0.281 (7.1)	0.812 (20.6)	0.510 (13.0)	12
10	9/16-24 UNEF	0.568 (14.4)	0.312 (7.9)	0.812 (20.6)	0.510 (13.0)	12
12	5/8-24 UNEF	0.630 (16.0)	0.375 (9.5)	0.875 (22.2)	0.573 (14.6)	16
14	11/16-24 UNEF	0.693 (17.6)	0.438 (11.1)	0.938 (23.8)	0.635 (16.2)	16
16	3/4-20 UNEF	0.755 (19.2)	0.500 (12.7)	1.000 (25.4)	0.698 (17.7)	20
20	7/8-20 UNEF	0.880 (22.4)	0.625 (15.9)	1.125 (28.6)	0.822 (20.9)	20
24	1-20 UNEF	1.005 (25.5)	0.750 (19.1)	1.250 (31.8)	0.948 (24.1)	24
28	1 3/16-8 UNEF	1.193 (30.3)	0.875 (22.2)	1.438 (36.5)	1.135 (28.8)	32
32	1 5/16-18 UNEF	1.318 (33.5)	1.000 (25.4)	1.562 (39.7)	1.260 (32.0)	32
36	1 7/16-18 UNEF	1.443 (36.7)	1.125 (28.6)	1.625 (41.3)	1.385 (35.2)	36
40	1 1/2-18 UNEF	1.505 (38.2)	1.250 (31.8)	1.812 (46.0)	1.448 (36.8)	40
48	1 3/4-18 UNS	1.755 (44.6)	1.500 (38.1)	2.062 (52.4)	1.698 (43.1)	48
52	1 7/8-18 UNS	1.880 (47.8)	1.625 (41.3)	2.125 (54.0)	1.823 (46.3)	52
56	2-18 UNS	2.005 (50.9)	1.750 (44.4)	2.312 (58.7)	1.938 (49.2)	56

Table II: Finish

Symbol	Finish Description
XMT	Nickel-PTFE Gray (1000 Hr. Salt Spray)
XM	Electroless Nickel
XW	Cadmium Olive Drab over Electroless Nickel
XMT	No Plating - Base Material, Non-Conductive

Table IV: Entry Code/Dimensions/Shrink Boot

Entry Code	Ø F Max	Conduit I.D.		Shrink Boot
		Min	Max	
06	.53 (13.5)	.16 (4.1)	.19 (4.8)	<a href="#">770-001S103</a>
09	.63 (16.0)	.24 (6.1)	.28 (7.1)	<a href="#">770-001S103</a>
12	.73 (18.5)	.33 (8.4)	.37 (9.4)	<a href="#">770-001S104</a>
16	.86 (21.8)	.45 (11.4)	.50 (12.7)	<a href="#">770-001S104</a>
20	.98 (24.9)	.57 (14.5)	.62 (15.8)	<a href="#">770-001S105</a>
24	1.15 (29.2)	.69 (17.5)	.75 (19.1)	<a href="#">770-001S106</a>
28	1.27 (32.3)	.81 (20.6)	.87 (22.2)	<a href="#">770-001S107</a>
32	1.40 (35.6)	.93 (23.6)	1.00 (25.4)	<a href="#">770-001S107</a>
36	1.53 (38.9)	1.07 (27.2)	1.13 (28.7)	<a href="#">770-001S107</a>
40	1.62 (41.1)	1.18 (30.0)	1.25 (31.8)	<a href="#">770-001S107</a>
48	1.98 (50.3)	1.45 (36.8)	1.50 (38.1)	<a href="#">770-001S108</a>
52	2.07 (52.6)	1.58 (40.1)	1.63 (41.4)	<a href="#">770-001S108</a>
56	2.14 (54.4)	1.70 (43.2)	1.75 (44.4)	<a href="#">770-001S108</a>