

### D38999 SERIES II TYPE WALL MOUNT RECEPTACLE

| How To Order           |  |   |    |       |   |   |   |   |   |   |
|------------------------|--|---|----|-------|---|---|---|---|---|---|
| Sample Part Number     | 240-382  | W | ME | 14-35 | P | S | P | A | C | N |
| Filter Connector       | MIL-DTL-38999 Series II Type   |   |    |       |   |   |   |   |   |   |
| Shell Style            | W = Wall Mount   |   |    |       |   |   |   |   |   |   |
| Connector Class        | See Table I  |   |    |       |   |   |   |   |   |   |
| Insert Arrangement     | IAW MIL-STD-1560. (See pages B-18 – B-19)                              |   |    |       |   |   |   |   |   |   |
| Contact Gender         | P = Pin S = Socket   |   |    |       |   |   |   |   |   |   |
| Termination            | S = Solder Cup P = PC Tail   |   |    |       |   |   |   |   |   |   |
| Filter Type            | P = Pi Circuit C = C Circuit (See Note 2)                              |   |    |       |   |   |   |   |   |   |
| Capacitance            | See Table II   |   |    |       |   |   |   |   |   |   |
| Flange Mounting Style  | H = Round Holes C = Clinch Nuts (4-40 UNC) M = Metric Clinch Nuts (M3) |   |    |       |   |   |   |   |   |   |
| Alternate Key Position | A, B, C, D, N = Normal (See page B-19)                                 |   |    |       |   |   |   |   |   |   |

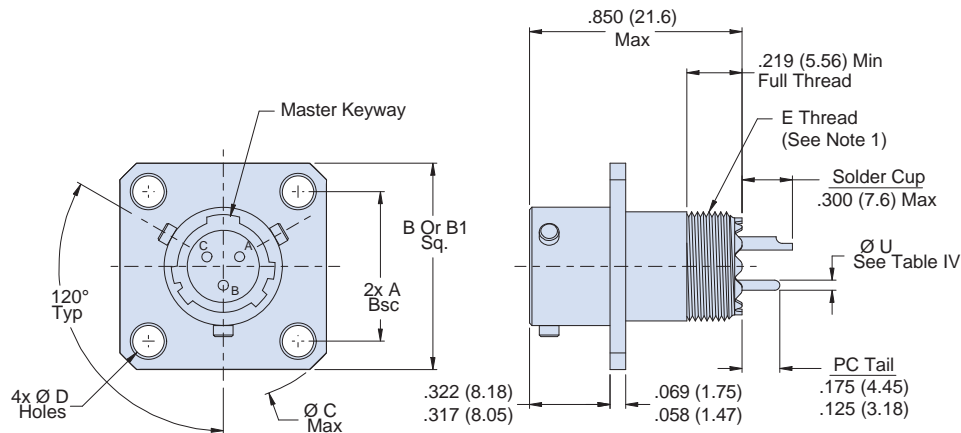

#### Notes

1. "E" accessory threads for shell size 8 thru 16 are one size larger than MIL-DTL-38999 Series II to accommodate filters
2. Other filter styles (C-L, L-C, Unbalanced Pi, Multi-Stage, Multi-Value) are available, please consult the factory.

Dimensions in inches (millimeters) and are subject to change without notice.

240-382W  
MIL-DTL-38999 Series II Type Filter Connector  
Wall Mount Receptacle



MIL-DTL-38999  
Type

B

| Table I: Connector Class |               |                 |  |
|--------------------------|---------------|-----------------|--|
| Sym                      | Class         | Material        | Finish Description                                     |
| ME                       | Environmental | Aluminum        | Electroless Nickel                                     |
| MT                       | Environmental | Aluminum        | Ni-PTFE 1000 Hour Grey™<br>Nickel Fluorocarbon Polymer |
| NF                       | Environmental | Aluminum        | Cadmium O.D. Over Electroless Nickel                   |
| ZL                       | Environmental | Stainless Steel | Electro-Deposited Nickel                               |
| ZN                       | Environmental | Aluminum        | Zinc-Nickel, Olive Drab                                |
| ZR                       | Environmental | Aluminum        | Zinc Nickel, Black - RoHS                              |
| H2*                      | Hermetic      | Stainless Steel | Electro-Deposited Nickel                               |

\*Some dimensions do not apply. See drawing 240-382WH2

| Table II: Capacitor Array Code Capacitance Range |                   |                  |
|--|-------------------|------------------|
| Class  | Pi - Circuit (pF) | C - Circuit (pF) |
| X*   | 160,000 - 240,000 | 80,000 - 120,000 |
| Y*   | 80,000 - 120,000  | 40,000 - 60,000  |
| Z*   | 60,000 - 90,000   | 30,000 - 45,000  |
| A  | 38,000 - 56,000   | 19,000 - 28,000  |
| B  | 32,000 - 45,000   | 16,000 - 22,500  |
| C  | 18,000 - 33,000   | 9,000 - 16,500   |
| D  | 8,000 - 12,000    | 4,000 - 6,000    |
| E  | 3,300 - 5,000     | 1,650 - 2,500    |
| F  | 800 - 1,300       | 400 - 650        |
| G  | 400 - 600         | 200 - 300        |
| J  | 70-120            | 35-60            |

\* Filter Classes X, Y and Z are 250 VDC.  
All others are 500 VDC

| Table IV: PC Tail Dia |             |
|-----------------------|-------------|
| Contact Size          | Ø U         |
| 22D                   | .021 (0.53) |
|                       | .018 (0.46) |
| 20                    | .031 (0.79) |
|                       | .029 (0.74) |
| 16                    | .042 (1.07) |
|                       | .038 (0.97) |
| 12                    | .096 (2.44) |
|                       | .092 (2.34) |

| Table III: Dimensions |              |                  |                                   |                    |              |                  |
|-----------------------|--------------|------------------|-----------------------------------|--------------------|--------------|------------------|
| Shell Size            | A Bsc        | Thru Hole Flange |                                   | Clinch Nut Flange  | Ø C Max      | E Thread UNEF-2A |
|                       |              | B Sq. Max        | Ø D<br>+.010 (.25)<br>-.005 (.13) | B1 Sq. ±.020 (.51) |              |                  |
| 8                     | .594 (15.1)  | .828 (21.0)      | .120 (3.0)                        | .895 (22.7)        | 1.250 (31.8) | .5625-24         |
| 10                    | .719 (18.3)  | .954 (24.2)      | .120 (3.0)                        | 1.019 (25.9)       | 1.400 (35.6) | .6875-24         |
| 12                    | .812 (20.6)  | 1.047 (26.6)     | .120 (3.0)                        | 1.112 (28.2)       | 1.500 (38.1) | .8125-20         |
| 14                    | .906 (23.0)  | 1.141 (29.0)     | .120 (3.0)                        | 1.206 (30.6)       | 1.650 (41.9) | .9375-20         |
| 16                    | .969 (24.6)  | 1.234 (31.3)     | .120 (3.0)                        | 1.269 (32.2)       | 1.700 (43.2) | 1.0625-18        |
| 18                    | 1.062 (27.0) | 1.328 (33.7)     | .120 (3.0)                        | 1.362 (34.6)       | 1.800 (45.7) | 1.0625-18        |
| 20                    | 1.156 (29.4) | 1.453 (39.9)     | .120 (3.0)                        | 1.456 (37.0)       | 2.000 (50.8) | 1.1875-18        |
| 22                    | 1.250 (31.8) | 1.578 (40.1)     | .120 (3.0)                        | 1.562 (39.7)       | 2.150 (54.6) | 1.3125-18        |
| 24                    | 1.375 (34.9) | 1.703 (43.3)     | .147 (3.7)                        | 1.719 (43.7)       | 2.280 (57.9) | 1.4375-18        |

Dimensions in inches (millimeters) and are subject to change without notice.