



SERIES 80

# Mighty Mouse Connectors and Cables



## 12/23, 16/23, and 20/23 Combo Contact Layouts and PCB Footprints; Tested at 750 Vac

Contact Size and Quantity				Contact Layouts					
#12	#16	#20	#23	Series 800	Series 801	Series 802	Series 803	Series 804	Series 805
1			12	10-200	10-200	10-200	10-200	10-200	12-200
2			4	10-201	10-201	10-201	10-201	10-201	12-201
2			6	12-200	13-200	12-200	12-200	12-200	15-200
2			10	12-201	13-201	12-201	12-201	12-201	15-201
	2		4	9-200	9-200	9-200	9-200	9-200	11-200
	2		8	10-202	10-202	10-202	10-202	10-202	12-202
	4		58	N/A	17-206	15-206	N/A	N/A	19-206
		2	4	8-200	8-200	8-200	8-200	8-200	10-200
		2	8	9-201	9-201	9-201	9-201	9-201	11-201

### SIZE 12 AND 23 COMBO CONTACT ARRANGEMENTS

Inert Arrangement  
Mating Face View of Pin Contacts

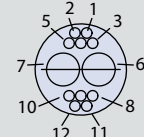
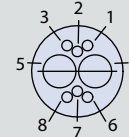
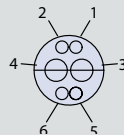
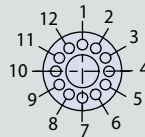

PCB Footprint

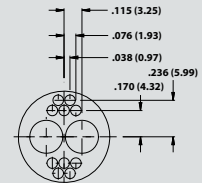
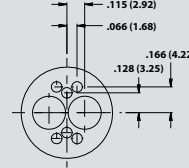
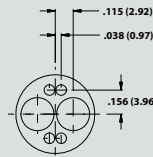
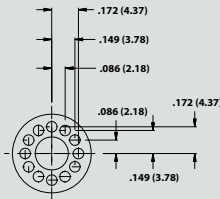

Series 800, 802, 803, 804	10-200		10-201		12-200		12-201	
Series 801	10-200		10-201		13-200		13-201	
Series 805	12-200		12-201		15-200		15-201	
Contact Size	#12	#23	#12	#23	#12	#23	#12	#23
No. of Contacts	1	12	2	4	2	6	2	10

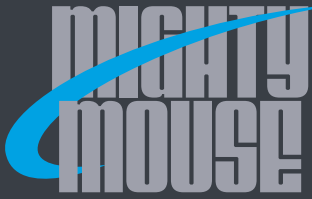

# SERIES 80

## Mighty Mouse Connectors and Cables



### Combo Contact Layouts and PCB Footprints Tested at 750 Vac

#### SIZE 16 AND 23 COMBO CONTACT ARRANGEMENTS (TESTED AT 750 VAC)

Inert Arrangement  
Mating Face View of Pin  
Contacts

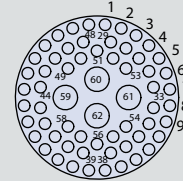
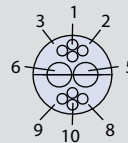
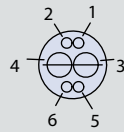

PCB Footprint

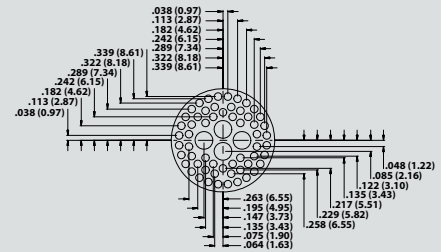
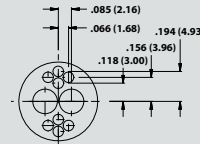
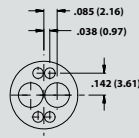

Series 800, 802, 803, 804	9-200		10-202		15-206 <sup>1,2</sup>	
Series 801	9-200		10-202		17-206	
Series 805	11-200		12-202		19-206	
Contact Size	#16	#23	#16	#23	#16	#23
No. of Contacts	2	4	2	8	4	58

#### SIZE 20 AND 23 COMBO CONTACT ARRANGEMENTS (TESTED AT 750 VAC)

Inert Arrangement  
Mating Face View of Pin  
Contacts

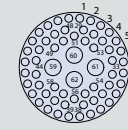
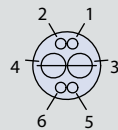

PCB Footprint

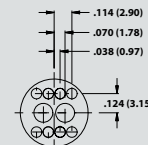
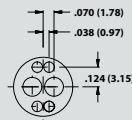

Series 800, 802, 803, 804	8-200		9-201	
Series 801	8-200		9-201	
Series 805	10-200		11-201	
Contact Size	#20	#23	#20	#23
No. of Contacts	2	4	2	8

1. Not available for Series 800 2. Not available for Series 803 or 804