

792-005S El Ochito® PCB Plug Connectors

Straight PC Tail Ochito Octaxial Contacts

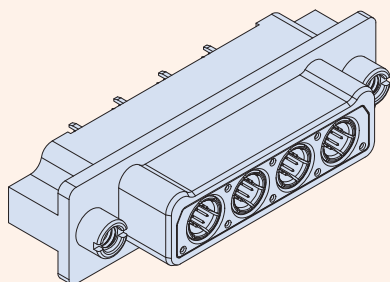

Ultraminiature. High-speed. Epoxy sealed. Series 792 connectors are intended for 10Gb Ethernet, USB 3.0 and other multi-gigabit protocols. 792-005S connectors feature Ochito octaxial contacts with straight printed circuit board tails, machined aluminum shells and environmental protection. Scoop-proof interface for problem-free service. Military-grade performance and construction.

Technical Data

Specifications

- Operating temperature: -65 to +125 °C
- Current rating, size 23 contact: 5A
- Current rating, Ochito contacts: 1.5A
- Voltage rating (DWV): 500 Vac
- Shock: EIA-364-27 condition D
- Vibration: EIA-364-28 condition V, letter E
- Insulation Resistance: 5000 MΩ min.
- Shell-to-shell resistance with EMI spring: 2.5 mΩ max.
- Altitude immersion: 75,000 feet

Construction

- Shell: aluminum alloy
- Metal insert: aluminum, nickel plated
- Insulators: high-grade rigid dielectric
- Size 23 contacts: copper alloy, 50 microinches gold over nickel plating
- Ochito contacts
inner and outer contacts: copper alloy, 50 microinches gold over nickel plating. Insulators: high-grade rigid thermoplastic. Spline: nickel-plated copper alloy (Ochito White), polyimide (Ochito Blue and Red)
- Hardware: 300 series SST, passivated

How To Order

	Sample P/N	792-005S	D-12P4	MT	P	AA
Product	792-005S = PCB Plug, Ochito Socket Contacts					
Insert Arrangement	See Table 2					
Shell Finish	M = Electroless Nickel MT = Nickel-PTFE					
Mating Hardware (Table 1)	N = No jackpost P = Jackpost R1 = Rear panel jackpost, .032 (0.81) panel R2 = Rear panel jackpost, .050 (1.27) panel R3 = Rear panel jackpost, .062 (1.59) panel R4 = Rear panel jackpost, .080 (2.03) panel R5 = Rear panel jackpost, .093 (2.36) panel R6 = Rear panel jackpost, .125 (3.18) panel					
El Ochito® Protocol Code	See Table 3 on following page					

Table 1 Mating Hardware

 N No Hardware Blind tapped holes	 P Jackposts 8-32 UNC-2B thread	 R1 – R6 Rear Panel Jackposts 8-32 UNC-2B thread.
--	--	--

Table 2 Insert Arrangements

Insert arrangement	Number of Contacts		Insert arrangement	Number of Contacts	
	#23	#8		#23	#8
A-1P1, A-1G1*		1	D-27P3	24	3
A-3P1	2	1	D-4P4, D-4G4*		4
B-23P1	22	1	D-12P4	8	4
B-2P2, B-2G2*		2	E-45P3	42	3
B-6P2	4	2	E-5P5, E-5G5*		5
C-24P2	22	2	E-15P5	10	5
C-3P3, C-3G3*		3	F-9P9, F-9G9*		9
C-9P3	6	3	F-31P9	22	9

Cavity identification numbers shown are for mating face of plug connectors with socket contacts.

* Insert arrangements with "G" designator are grounded type with metal insert. Insert arrangements with "P" designator have thermoplastic dielectric.

SERIES 792

High-Speed Ultraminiature Rectangular Connectors



792-005S El Ochito® PCB Plug Connectors

Straight PC Tail Ochito Octaxial Contacts

Ochito Protocols

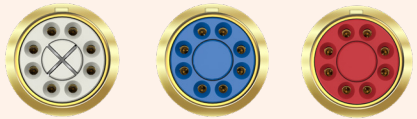

WHITE
10GBASE-T

BLUE
USB 3.0

RED
HDMI, SATA,
DisplayPort

The Ochito octaxial contact has a color-coded insulator signifying the data protocol. White is used for 10 Gb Ethernet, blue is used for USB 3.0, and red is used for multi gigabit 100 ohm protocols including HDMI, DisplayPort and SATA. The connector part number includes a protocol code from Table 3. This code enables combinations of these protocols.



Code AE



Code AQ

Table 3 Protocol Code

Code	Cavity									Code	Cavity								
	A1	A2	A3	A4	A5	A6	A7	A8	A9		A1	A2	A3	A4	A5	A6	A7	A8	A9
AA	W	W	W	W	W	W	W	W	W	BF	B	B	B	B	B	B	W	W	
AB	B	W	W	W	W	W	W	W	W	BG	R	B	B	B	B	B	W	W	
AC	R	W	W	W	W	W	W	W	W	BH	R	R	B	B	B	B	W	W	
AD	B	B	W	W	W	W	W	W	W	BJ	R	R	R	B	B	B	W	W	
AE	R	B	W	W	W	W	W	W	W	BK	R	R	R	R	B	B	W	W	
AF	R	R	W	W	W	W	W	W	W	BL	R	R	R	R	R	B	W	W	
AG	B	B	B	W	W	W	W	W	W	BM	R	R	R	R	R	R	W	W	
AH	R	B	B	W	W	W	W	W	W	BN	R	R	R	R	R	R	W	W	
AJ	R	R	B	W	W	W	W	W	W	BP	B	B	B	B	B	B	W	W	
AK	R	R	R	W	W	W	W	W	W	BQ	R	B	B	B	B	B	W	W	
AL	B	B	B	B	W	W	W	W	W	BR	R	R	B	B	B	B	W	W	
AM	R	B	B	B	W	W	W	W	W	BS	R	R	R	B	B	B	W	W	
AN	R	R	B	B	W	W	W	W	W	BT	R	R	R	R	B	B	W	W	
AP	R	R	R	B	W	W	W	W	W	BV	R	R	R	R	R	B	W	W	
AQ	R	R	R	R	W	W	W	W	W	BW	R	R	R	R	R	R	W	W	
AR	B	B	B	B	B	W	W	W	W	BX	R	R	R	R	R	R	W	W	
AS	R	B	B	B	B	W	W	W	W	BY	R	R	R	R	R	R	W	W	
AT	R	R	B	B	B	W	W	W	W	BZ	B	B	B	B	B	B	W	W	
AV	R	R	R	B	B	W	W	W	W	CA	R	B	B	B	B	B	W	W	
AW	R	R	R	R	B	W	W	W	W	CB	R	R	B	B	B	B	W	W	
AX	R	R	R	R	R	W	W	W	W	CC	R	R	R	B	B	B	W	W	
AY	B	B	B	B	B	B	W	W	W	CD	R	R	R	R	B	B	W	W	
AZ	R	B	B	B	B	B	W	W	W	CE	R	R	R	R	R	B	W	W	
BA	R	R	B	B	B	B	W	W	W	CF	R	R	R	R	R	R	W	W	
BB	R	R	R	B	B	B	W	W	W	CG	R	R	R	R	R	R	W	W	
BC	R	R	R	R	B	B	W	W	W	CH	R	R	R	R	R	R	W	W	
BD	R	R	R	R	R	B	W	W	W	CJ	R	R	R	R	R	R	W	W	
BE	R	R	R	R	R	R	W	W	W										

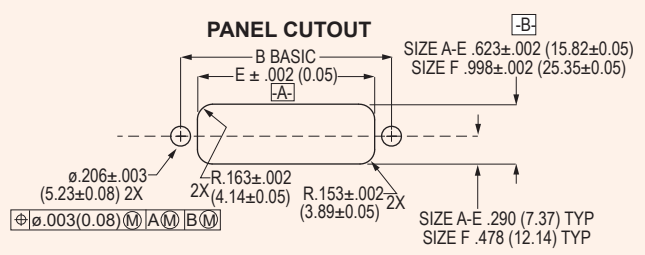
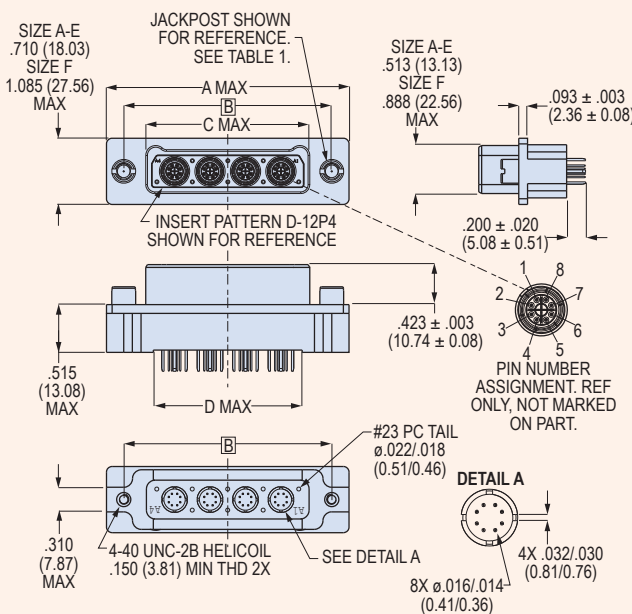

792-005S Dimensions

Shell Size	A Max		B Basic		C Max		D Max		E ±.002 (0.05)	
	In.	mm.	In.	mm.	In.	mm.	In.	mm.	In.	mm.
A	1.455	36.96	1.075	27.31	.615	15.62	.460	11.68	.725	18.42
B	1.830	46.48	1.450	36.83	.990	25.15	.835	21.21	1.100	27.94
C	2.205	56.01	1.825	46.36	1.365	34.67	1.210	30.73	1.475	37.47
D	2.580	65.53	2.200	55.88	1.740	44.20	1.585	40.26	1.850	46.99
E	2.955	75.06	2.575	65.41	2.115	53.72	1.960	49.78	2.225	56.52
F	2.955	75.06	2.575	65.41	2.115	53.72	1.960	49.78	2.225	56.52

792-005S El Ochito[®] PCB Plug Connectors

Straight PC Tail Ochito Octaxial Contacts

792-005S Printed Circuit Board Layouts

SHELL SIZE A

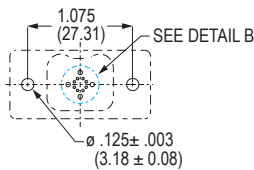

A-1P1, A-1G1

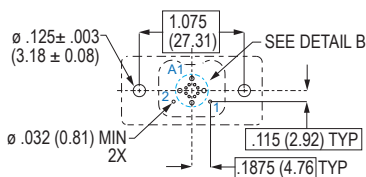

A-3P1

SHELL SIZE B

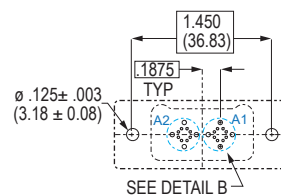

B-2P2, B-2G2

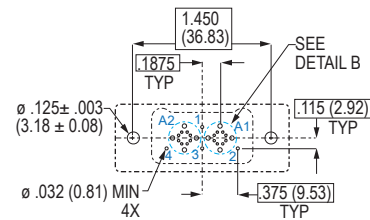

B-6P2

SHELL SIZE C

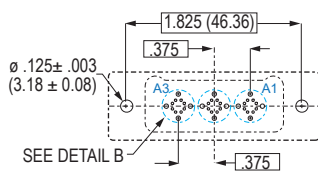

C-3P3, C-3G3

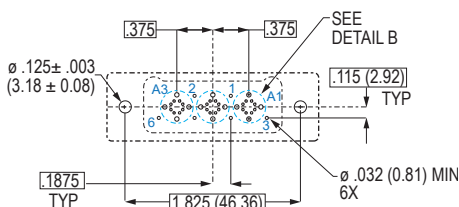

C-9P3

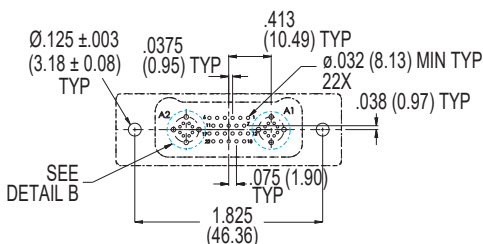

C-24P2

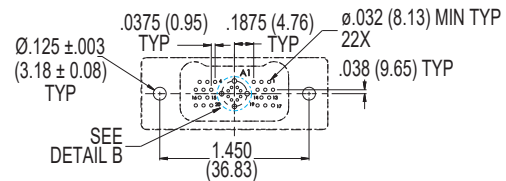

B-23P1

