



## Modification Codes

### MODIFICATION CODE -686 POLARIZING OPTIONS

Standard SuperFly® connectors feature a single key and keyway for shell polarization. Optional alternate key positions are available for situations where multiple connectors are used. Add the suffix code shown below to the part number. Example: 882-01-M-01-**686A**.

Alternate Key Positions			
Key Position	Suffix Code	A°	B°
A	686A	150°	210°
B	686B	75°	210°
C	686C	95°	230°
D	686D	140°	275°
E	686E	75°	275°
F	686F	95°	210°

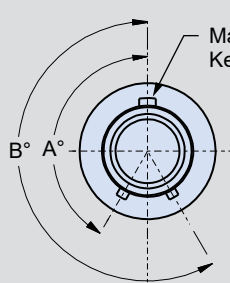

Plug Key Positions

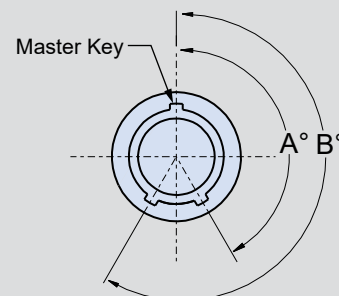

Receptacle Key Positions

### MODIFICATION CODE -429 SPECIAL INSPECTION PER NASA EEE-INST-002

Modification code -429 is added to the end of a part number for special inspection per NASA EEE-INST-002. Example: 882-01-M-01-**492B**.

#### NASA Screening Level and Available Outgassing Modification Codes

Screening Level	Screening Only	48 Hour Oven Bake 175° C	Thermal Vacuum Outgassing (10-6 Torr)	
			24 Hour 125° C	48 Hour 175° C
NASA, Level 1 – Highest Reliability	429B	429J	429C	
NASA, Level 2 – High Reliability	429	429K	429A	429AA
NASA, Level 3 – Std. Reliability	Use Standard Part Number		429L	

#### El Ochito® White

Component	Material	TML%	CVCM%	Test Reference
Inner & Outer Insulator	Fortron 1200 L1	0.07	<0.01	Glenair test at Pacific Testing Laboratories 2-22-2022 TR73209
O-Ring & Cable Grommet (Receptacles & Cable Connectors Only)	70/30 Fluorosilicone/Silicone Blend per GPS78 Grade 40	0.12	0.02	Glenair test at Pacific Testing Laboratories 6-17-2020
Rear Insulator (PC Tail Only)	PTFE	0.01	0.00	NASA Outgassing Data for Selecting Spacecraft Materials
Epoxy (PC Tail Only)	Hysol EE-4215	0.55	<0.01	Glenair test at Pacific Testing Laboratories 7-25-2017 TR59899-3
Housing (Right Angle PCB Mount Only)	Ryton, 40% Glass Filled	0.09	0.00	NASA Outgassing Data for Selecting Spacecraft Materials
Flex Board (Right Angle PCB Mount Only)	Various	0.36	0.01	Glenair test at Pacific Testing Laboratories 6-1-2022 TR73949
Ink Marking	Markem-Imaje 7224 Series	0.41	0.04	NASA Outgassing Data for Selecting Spacecraft Materials

## Modification Codes

### MODIFICATION CODE -429 SPECIAL INSPECTION PER NASA EEE-INST-002 (CONTINUED)

El Ochito® Blue				
Component	Material	TML%	CVCM%	Test Reference
Inner & Outer Insulator	GPS169	0.20	<0.01	Glenair test at Pacific Testing Laboratories 7-19-2021 TR71364
O-Ring & Cable Grommet (Receptacles & Cable Connectors Only)	70/30 Fluorosilicone/Silicone Blend per GPS78 Grade 40	0.12	0.02	Glenair test at Pacific Testing Laboratories 6-17-2020
Rear Insulator (PC Tail Only)	PTFE	0.01	0.00	NASA Outgassing Data for Selecting Spacecraft Materials
Epoxy (PC Tail Only)	No.1 Vary Flex	0.29	0.01	NASA Outgassing Data for Selecting Spacecraft Materials
Housing (Right Angle PCB Mount Only)	Ryton, 40% Glass Filled	0.09	0.00	NASA Outgassing Data for Selecting Spacecraft Materials
Epoxy (Right Angle PCB Mount Only)	Hysol EE-4215	0.55	<0.01	Glenair test at Pacific Testing Laboratories 7-25-2017 TR59899-3
Flex Board (Right Angle PCB Mount Only)	Various	0.36	0.01	Glenair test at Pacific Testing Laboratories 6-1-2022 TR73949
Ink Marking	Markem-Imaje 7224 Series	0.41	0.04	NASA Outgassing Data for Selecting Spacecraft Materials

El Ochito® Red				
Component	Material	TML%	CVCM%	Test Reference
Inner & Outer Insulator	GPS173	0.20	0.01	Glenair test at Pacific Testing Laboratories 7-19-2021 TR71364
O-Ring & Cable Grommet (Receptacles & Cable Connectors Only)	70/30 Fluorosilicone/Silicone Blend per GPS78 Grade 40	0.12	0.02	Glenair test at Pacific Testing Laboratories 6-17-2020
Rear Insulator (PC Tail Only)	PTFE	0.01	0.00	NASA Outgassing Data for Selecting Spacecraft Materials
Epoxy (PC Tail Only)	No.1 Vary Flex	0.29	0.01	NASA Outgassing Data for Selecting Spacecraft Materials
Housing (Right Angle PCB Mount Only)	Ryton, 40% Glass Filled	0.09	0.00	NASA Outgassing Data for Selecting Spacecraft Materials
Epoxy (Right Angle PCB Mount Only)	Hysol EE-4215	0.55	<0.01	Glenair test at Pacific Testing Laboratories 7-25-2017 TR59899-3
Flex Board (Right Angle PCB Mount Only)	Various	0.36	0.01	Glenair test at Pacific Testing Laboratories 6-1-2022 TR73949
Ink Marking	Markem-Imaje 7224 Series	0.41	0.04	NASA Outgassing Data for Selecting Spacecraft Materials